

**CONSERVATION EASEMENT MAP
CABBAGE BLUFF AND DOVER HALL,
GLYNN COUNTY, GEORGIA**

FOR: ST. ANDREWS PLANTATION, LLC

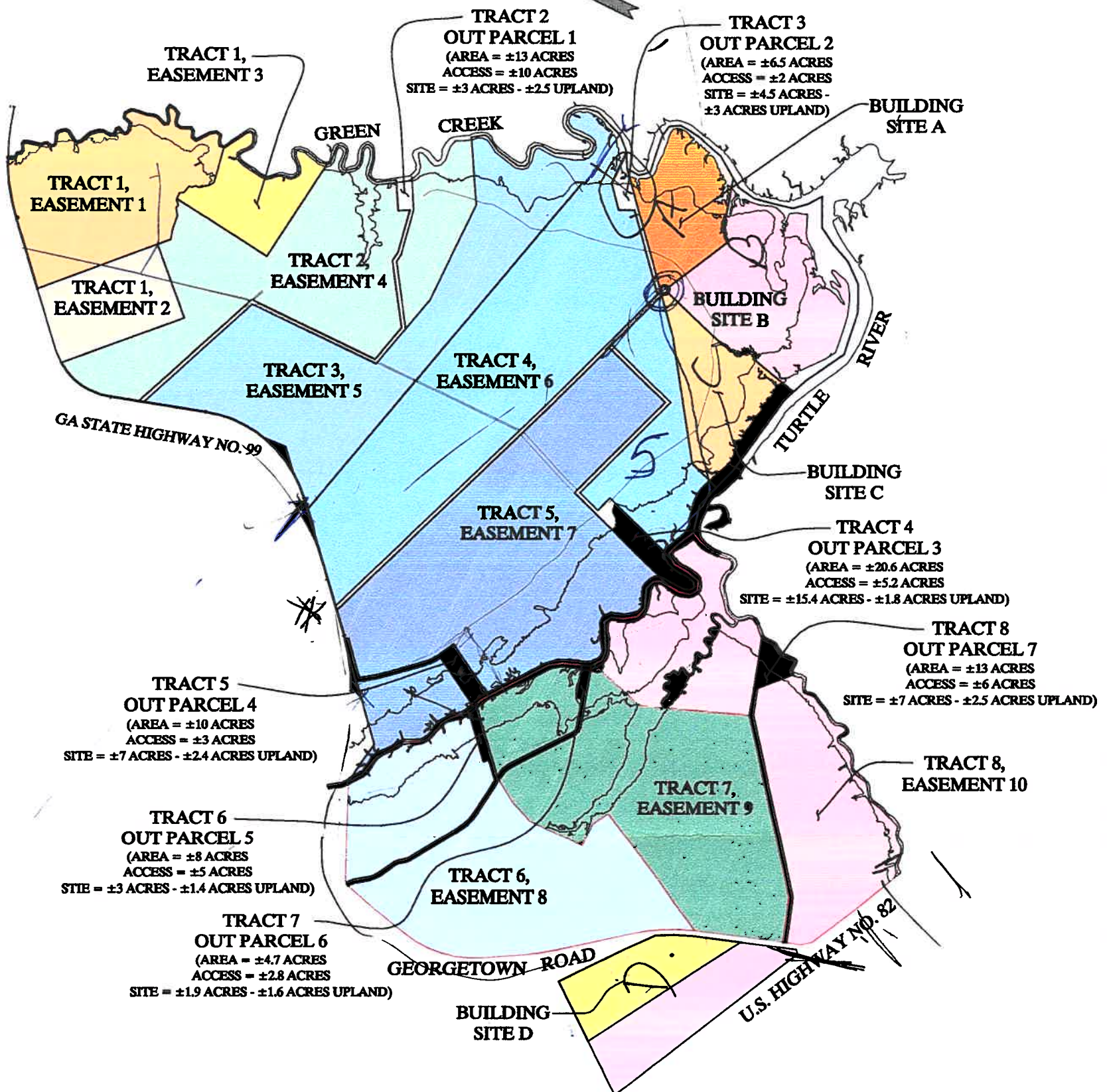

CONSERVATION EASEMENTS AND BUILDING SITES

NOTE:

OUTPARCELS ARE PART OF THE LARGER TRACTS THAT LIE OUTSIDE OF THE CONSERVATION EASEMENT.

TRACT 1, EASEMENT 1	ST. ANDREWS PLANTATION, LLC (D.B. 1594, PG. 241) CONSERVATION EASEMENT (D.B. 2944, PG. 223); EASEMENT AREA = ±140.4 ACRES
TRACT 1, EASEMENT 2	ST. ANDREWS PLANTATION, LLC (D.B. 1594, PG. 241) CONSERVATION EASEMENT (D.B. 3093, PG. 327); EASEMENT AREA = 60.00 ACRES
TRACT 1, EASEMENT 3	ST. ANDREWS PLANTATION, LLC (D.B. 1594, PG. 241) CONSERVATION EASEMENT (D.B. 3093, PG. 334) EASEMENT AREA = ±46.6 ACRES
TRACT 2, EASEMENT 4	GREEN CREEK, LLC (D.B. 3257, PG. 148) CONSERVATION EASEMENT (D.B. 3260, PG. 470) EASEMENT AREA = ±256 ACRES
TRACT 3, EASEMENT 5	HABITAT GREEN INVESTMENTS, LLC (D.B. 3257, PG. 123) CONSERVATION EASEMENT (D.B. 3260, PG. 499) EASEMENT AREA = ±251.5 ACRES
TRACT 4, EASEMENT 6	CABBAGE BLUFF, LLC (D.B. 3257, PG. 161, ex) CONSERVATION EASEMENT (D.B. 3261, PG. 1) EASEMENT AREA = ±378 ACRES
TRACT 5, EASEMENT 7	TURTLE RIVER PROPERTIES, LLC (D.B. 3259, PG. 127 & D.B. 3257, PG. 136) CONSERVATION EASEMENT (D.B. 3261, PG. 31) EASEMENT AREA = ±370 ACRES
TRACT 6, EASEMENT 8	GEORGETOWN RIVERFRONT PROPERTY, LLC (D.B. 3373, PG. 451) CONSERVATION EASEMENT (D.B. 3380, PG. 131) EASEMENT AREA = ±280 ACRES
TRACT 7, EASEMENT 9	SALT MARSH INVESTMENTS, LLC (D.B. 3373, PG. 442) CONSERVATION EASEMENT (D.B. 3380, PG. 158) EASEMENT AREA = ±290.3 ACRES
TRACT 8, EASEMENT 10	COLLEGE CREEK PROPERTY, LLC (D.B. 3373, PG. 446) CONSERVATION EASEMENT (D.B. 3380, PG. 185) EASEMENT AREA = ±240 ACRES
BUILDING SITE A	TOTAL AREA = ±63 ACRES; UPLAND AREA = ± 33 ACRES.
BUILDING SITE B	TOTAL AREA = ±136 ACRES; UPLAND AREA = ± 70 ACRES.
BUILDING SITE C	TOTAL AREA = ±68 ACRES; UPLAND AREA = ± 41 ACRES.
BUILDING SITE D	TOTAL AREA = ±50 ACRES;

REVISED: MARCH 25, 2022

DATE: JANUARY 07, 2016

JACKSON SURVEYING, INC.
Surveyors and Land Planners

3526 DARIEN HIGHWAY, SUITE 217
BRUNSWICK, GEORGIA 31525

Ofc. (912) 265-3856
Fax. (912) 265-9509

email: info@brunswicksurveyor.com

2000' 1000' 0' 1000' 2000' 4000'



GRAPHIC SCALE: 1" = 2000'